



SCOOTER



PART DESCRIPTION

TOOLS REQUIRED FOR PROPER ASSEMBLY
13mm Spanner

WARNINGS

Caution and care must be taken in the unpacking and assembly of this product. Due to small parts and packaging materials, Adult assembly is required.

It is not recommended for riders over 20kg in weight.

Use under adult supervision at all times.

Check regularly for wear and tear. Discontinue use if breakage is found. Failure to do this may result in injury.

Do not allow more than one child to use this product at the same time.

ASSEMBLY INSTRUCTIONS:

- 1 Slide metal washer down over the stem of the front forks. Slide the stem of the front forks up into the main frame until it is seated on the metal washer at the base of the front forks stem.
- 2 Place the clamp bracket assembly over the stem of the front forks so that the nut and bolt face towards the footplate. Ensure the slot in the fork stem of the front forks faces towards the footplate.
- 3 Slide the plastic cap up the stem of the handlebar assembly as far as it will go. Lower the handlebar assembly as far as possible inside the front fork stem ensuring that the max. insertion mark on the handlebar assembly is not visible and the handlebars are aligned at right angles to the front wheel.
- 4 Secure the handlebars by tightening the clamp nut using a 13mm spanner until the nut will no longer turn. The nut is designed to prevent overtightening. Slide the plastic cap down over the clamp bracket to prevent injury. Push foam insert for handlebar pad centrally onto handlebar and wrap printed cover around, securing with velcro.

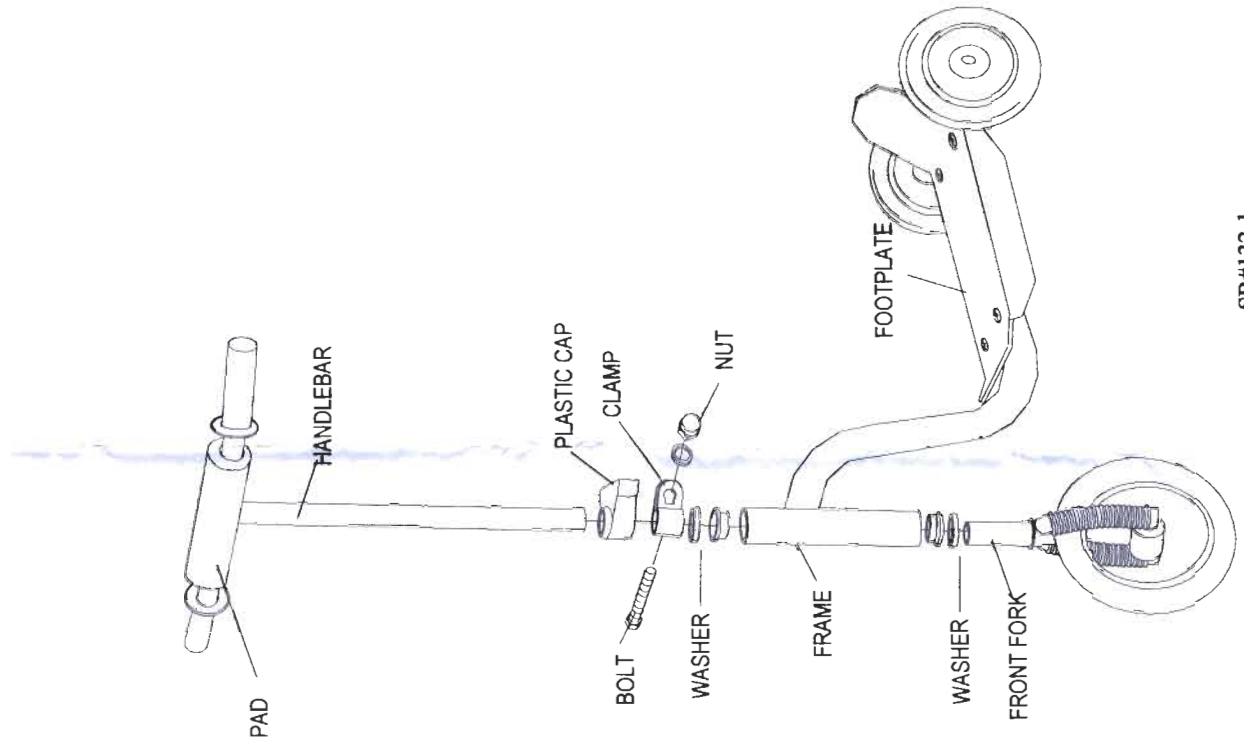

PARENT'S RESPONSIBILITY

- Be sure to read all the instructions carefully and assemble the scooter according to this instruction before you allow the child to ride.
- This scooter requires assembly by a qualified adult.
- Special care should be taken to instruct children in safe riding.
- Children should be SUPERVISED WHILE RIDING THIS SCOOTER.
- Check the scooter before the child rides to determine if there are any potentially hazardous parts or conditions.
- DO NOT ALLOW THE CHILD TO RIDE AT NIGHT.
- Do not allow this scooter to be ridden on streets or areas with auto traffic.
- Child should always wear a bicycle helmet which complies with ANSI(Z790.4) or snell requirements.
- Be sure the rider is wearing appropriate footwear when riding the scooter.
- Be sure the rider keeps both hands on the handlebars for proper control.
- Do not allow the rider to wear anything that obstructs hearing, visibility or function.
- Do not allow more than one rider on the scooter at a time.
- Do not allow this scooter to be operated on or near streets, sloped driveways, alleys, hills, ditches, in ground pools areas near steps or any other hazardous areas.
- THIS SCOOTER DOES NOT HAVE A BRAKE
- THIS SCOOTER DOES NOT HAVE REFLECTORS(DO NOT RIDE AFTER DARK)